

DESCHUTES COUNTY OFFICIAL RECORDS  
NANCY BLANKENSHIP, COUNTY CLERK

2011-30892



\$73.00

00797282201100308920060065

09/01/2011 04:00:19 PM

D-CCR Cnt=1 Stn=1 BN

\$25.00 \$5.00 \$11.00 \$16.00 \$10.00 \$6.00

Do not remove this page from original document.

# Deschutes County Clerk

## Certificate Page

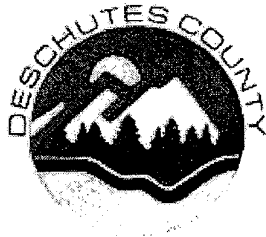

✓ 173  
✓ 163

AFTER RECORDING RETURN TO:

Deschutes Landing Owners Association  
c/o Crystal Lake Property Management  
63088 NE 18<sup>th</sup> St, Ste 101  
Bend OR 97701

Deschutes County Official Records **2011-029852**  
D-CCR  
Stn=3 PAMG **08/25/2011 03:16:25 PM**  
\$15.00 \$11.00 \$10.00 \$16.00 \$6.00 **\$58.00**

I, Nancy Blankenship, County Clerk for Deschutes County, Oregon,  
certify that the instrument identified herein was recorded in the Clerk  
records.

Nancy Blankenship - County Clerk

Being rerecorded at the request of Deschutes  
Landing Owners Assn to attach correct  
exhibit previously recorded in 2011-29852

✓

FIRST AMENDMENT TO  
DECLARATION OF PROTECTIVE COVENANTS, CONDITIONS,  
RESTRICTIONS AND EASEMENTS  
FOR DESCHUTES LANDING  
AMENDED AND RESTATED

THIS FIRST AMENDMENT TO DECLARATION OF PROTECTIVE COVENANTS,  
CONDITIONS, RESTRICTIONS AND EASEMENTS FOR DESCHUTES LANDING AMENDED  
AND RESTATED is made this 25 day of August, 2011, by DESCHUTES LANDING OWNERS  
ASSOCIATION (the "Association").

RECITALS

- A. The Declaration of Protective Covenants, Conditions, Restrictions and Easements for Deschutes Landing Amended and Restated was recorded July 20, 2007 in the records of Deschutes County, Oregon as Documents 2007-40127, (the "Declaration").
- B. The Owners have identified that there is lack of sufficient parking for residents of Lot 17 and Lot 18, both of which have a single car garage and a driveway of insufficient space to accommodate vehicle parking. The remaining homes in the Association do not have this particular vehicle parking deficiency.
- C. In accordance with Section 4.3 (e) of the Declaration, by affirmative vote or written consent of Owners holding not less than seventy-five percent (75%) of the Association, together with the written consent of the Class B member, the Owners wish to modify the classification of two parking spaces located in Common Area Tract D from Common Area to Limited Common Easement Areas for the benefit of Lot 17 and Lot 18 as identified on the attached Exhibit A incorporated hereto.
- D. In accordance with Section 12.1 of the Declaration, by affirmative vote or written consent of Owners holding not less than seventy-five percent (75%) of the Association, together with the written consent of the Class B member, the Owners wish to amend the Declaration.

After recording, return to  
Amerititle  
15 OREGON AVENUE, BEND

→ em  
→

Recorded by AmeriTitle as an  
accommodation only. No liability  
is accepted for the condition of  
title or for the validity, sufficiency,  
or effect of this document.

↓63

AFTER RECORDING RETURN TO:

Deschutes Landing Owners Association  
c/o Crystal Lake Property Management  
63088 NE 18<sup>th</sup> St, Ste 101  
Bend OR 97701

FIRST AMENDMENT TO  
DECLARATION OF PROTECTIVE COVENANTS, CONDITIONS,  
RESTRICTIONS AND EASEMENTS  
FOR DESCHUTES LANDING  
AMENDED AND RESTATED

THIS FIRST AMENDMENT TO DECLARATION OF PROTECTIVE COVENANTS, CONDITIONS, RESTRICTIONS AND EASEMENTS FOR DESCHUTES LANDING AMENDED AND RESTATED is made this 25 day of August, 2011, by DESCHUTES LANDING OWNERS ASSOCIATION (the "Association").

RECITALS

- A. The Declaration of Protective Covenants, Conditions, Restrictions and Easements for Deschutes Landing Amended and Restated was recorded July 20, 2007 in the records of Deschutes County, Oregon as Documents 2007-40127, (the "Declaration").
- B. The Owners have identified that there is lack of sufficient parking for residents of Lot 17 and Lot 18, both of which have a single car garage and a driveway of insufficient space to accommodate vehicle parking. The remaining homes in the Association do not have this particular vehicle parking deficiency.
- C. In accordance with Section 4.3 (e) of the Declaration, by affirmative vote or written consent of Owners holding not less than seventy-five percent (75%) of the Association, together with the written consent of the Class B member, the Owners wish to modify the classification of two parking spaces located in Common Area Tract D from Common Area to Limited Common Easement Areas for the benefit of Lot 17 and Lot 18 as identified on the attached Exhibit A incorporated hereto.
- D. In accordance with Section 12.1 of the Declaration, by affirmative vote or written consent of Owners holding not less than seventy-five percent (75%) of the Association, together with the written consent of the Class B member, the Owners wish to amend the Declaration.

After recording, return to  
Amerititle  
15 OREGON AVENUE, BEND

→em

Recorded by AmeriTitle as an  
accommodation only. No liability  
is accepted for the condition of  
title or for the validity, sufficiency,  
or effect of this document.

AMENDMENT

1. Article 2.2 (f) of the Declaration shall be amended to read as follows:

Limited Common Easement Areas shall be the Storm Drain Easements and Private Utility Service Easement Areas as shown on the plat of the Initial Development, and the parking easements in Common Tract D for the benefit of Lot 17 and Lot 18 as shown on the First Amendment Exhibit A.

DESCHUTES LANDING OWNERS ASSOCIATION

  
Cory Bittner, President

CERTIFICATION

The undersigned President of Deschutes Landing Owners Association hereby certifies that the within First Amendment to Declaration of Protective Covenants, Conditions, Restrictions and Easements for Deschutes Landing Amended and Restated has been approved and adopted in accordance with Section 12.1 of the Declaration.

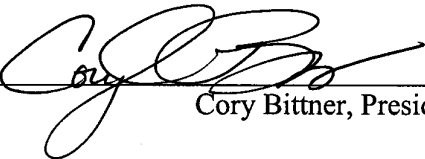
By:   
Cory Bittner, President

STATE OF OREGON        )  
                                  )ss  
County of Deschutes    )

The foregoing was acknowledged before me this 25 day of August, 2011 by Cory Bittner as President of Deschutes Landing Owners Association.

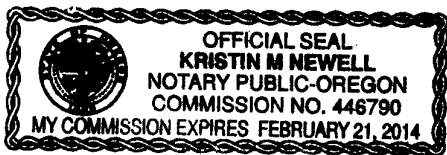

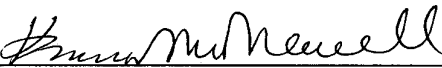
  
Notary Public of Oregon  
My Commission Expires: February 21, 2014

20' W 99.04'

**Exhibit A**  
LOT 18  
3,974 SF  
[F]

N 33° 13' 28" W 82.35'

COMMON  
TRACT 'D'  
20,824 SF

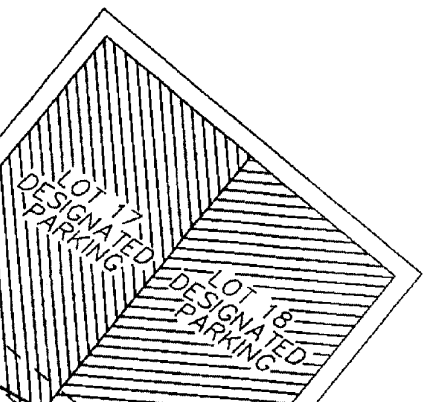

18'

51' 35"

.01 18  
974 SF  
[F]

COMMON  
TRACT 'D'  
20,824 SF

N46°22'01"E  
6.00'(m,r1)

(m,r1)  
12.57'

LOT 18  
DESIGNATED  
PARKING

LOT 17  
DESIGNATED  
PARKING

99.04'

C36

C35

