

Grantor shall have the right to use the lands subject to the above-described easement and right-of-way for all purposes not inconsistent with the uses and purposes herein set forth; provided that Grantor shall not build or erect any structure upon said easement and right-of-way without the prior written consent of Grantee.

All rights hereunder shall cease if and when such line shall have been abandoned.

Dated this 14 day of April, 1993.

[Signature]
BY Pres (Title)

Attest: _____ (Title)

State of Oregon
County of Deschutes

On this 14th day of April, in the year 1993, before me RICHARD W. SEALS, a Notary Public, personally appeared JAN L. WARD

_____, personally known to me (or proved to me on the basis of satisfactory evidence) to be the person who executed the within instrument as JAN L. WARD, President or on behalf of the corporation therein named and acknowledged to me that the corporation executed it.

IN WITNESS WHEREOF, I have hereunto set my hand and official seal the day and year above written.



[Signature]
Notary Public for Oregon
Residing at 20500 Mustang Rd
My Commission expires: 8-31-96

EXHIBIT "A"

"AS BUILT"

MOUNTAIN HIGH - 35 LOTS
 UG. TO ASPEN VILLAGE
 BEND, OREGON

PACIFIC POWER & LIGHT COMPANY
 PORTLAND, OREGON

APPROVED: _____
 SHEET 1 OF 1 PB

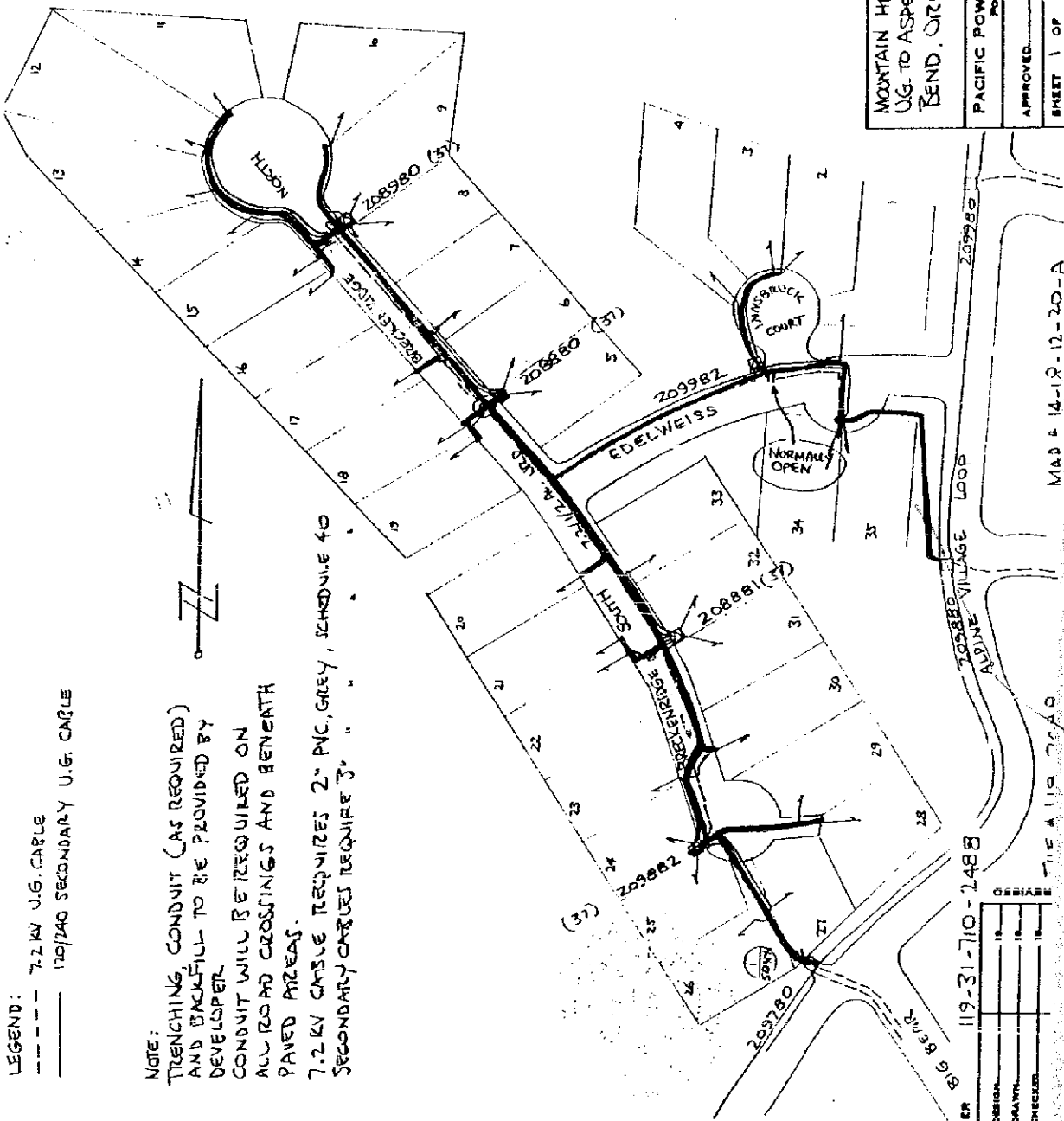

LEGEND:
 --- 7.2KV U.G. CABLE
 - - - 110/240 SECONDARY U.G. CABLE

NOTE:
 TRENCHING CONDUIT (AS REQUIRED) AND BACKFILL TO BE PROVIDED BY DEVELOPER.
 CONDUIT WILL BE REQUIRED ON ALL ROAD CROSSINGS AND BENEATH PAVED AREAS.
 7.2KV CABLE REQUIRES 2" PVC, GREY, SCHEDULE 40 SECONDARY CABLES REQUIRE 3" "

DESIGN: _____
 DRAWN: _____
 CHECKER: _____

STATE OF OREGON)
 COUNTY OF DISCHUTES) SS.

I, MARY SUE PENHOLLOW, COUNTY CLERK AND RECORDER OF CONVEYANCES, IN AND FOR SAID COUNTY, DO HEREBY CERTIFY THAT THE WITHIN INSTRUMENT WAS RECORDED THIS DAY:

93 APR 20 PM 2:46

MARY SUE PENHOLLOW
 COUNTY CLERK

BY: *M. Bartko* DEPUTY
 NO. **93-12373** FEES **300**
 DISCHUTES COUNTY OFFICIAL RECORDS

MAD # 14-12-12-20-A